



VIMBLE 2S

3-Axis Stabilized Handheld Gimbal
for Smartphone

Instructions

EN V1.0

Catalogue

1. Overview	1
2. Start to Use	2
2.1 Charging	2
2.2 Positioning Lock	2
2.3 Smartphone Installation	3
2.4 Balancing	3
2.5 Power ON / OFF	4
3. Function Operation	4
3.1 Function / Modes Introduction	4
3.2 Joystick	5
3.3 Function Button Operation	5
3.4 Shutter Button Operation	6
3.5 Focus Button Operation	7
3.6 Trigger Button Operation	7
3.7 Light Indicator Explanation	7
3.8 Trigger Button Operation	8
3.9 Landscape and Portrait Shot Switching	8
3.10 Gimbal Initialization	9
3.11 Smartphone Charging	10
4. Connect and Use Feiyu ON App	11
5.1 Download the App	11
5.2 Connect the App	11
5.3 Shooting / control interface	12
5.4 Firmware Upgrade	12
5. Specifications	13

Vimble 2S is a three-axis handheld gimbal suitable for mobile phones with joystick, Bluetooth shutter, position lock, extendable bar, etc. The gimbal can stabilize the smartphone intelligently. The gimbal supports landscape and portrait shooting, which can also control phone shooting. Connect with Feiyu ON App to achieve move functions

Suggestion

Vimble 2S includes below information, please read the information before using the gimbal

1. Quick start guide
2. Online instruction
3. Tutorial

The tutorial videos can be watched at FeiyuTech official website or scan the QR code as below: <http://www.feiyu-tech.com/play/>



Download the Feiyu ON App

Scan the QR code to download the app, or search for "Feiyu ON" in the App Store or Google Play.

* Requires iOS 9.0 or above, Android 6.0 or above.



iOS Version



Android Version



App Store



Google play

1. Overview

*This product does not include the smartphone

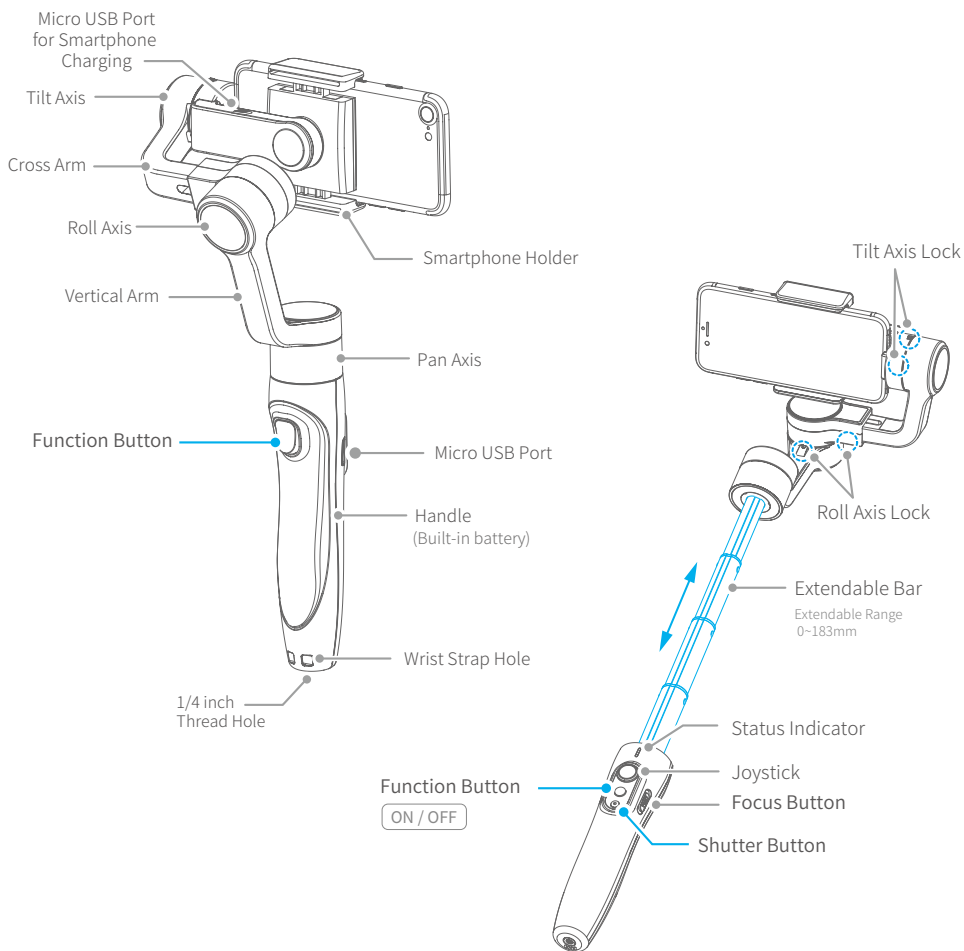

Accessories



Micro-USB Cable

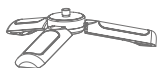

Tripod



Wrist Strap

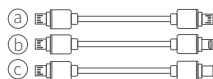

- a. Micro to Micro cable
- b. Micro to Lightning cable
- c. Micro to Type-C cable

2. Start to Use

TIPS

- (1) Please fully charge the battery before powering on the gimbal for the first time.
- (2) If the power is too low, the red light will flash three times every five seconds that indicating you should charge it immediately.
- (3) When not in use, power off the gimbal.
- (4) Unlock the three axis clamp before powering on the gimbal.

2.1. Charging

Connect the USB cable to charge. The indicator light is red when charging, and green when fully charged.

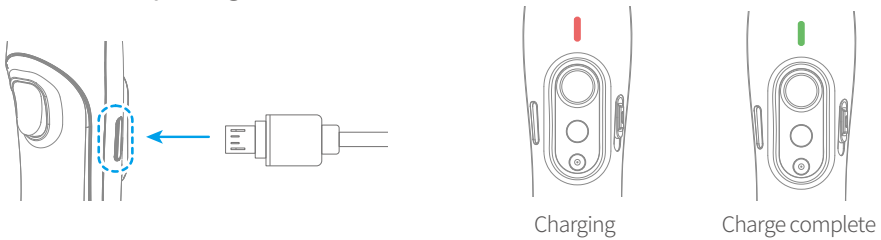

2.2. Positioning Lock

Each of the tilt axis and roll axis has positioning lock for storage purposes.

Be sure to unlock them before using the gimbal.

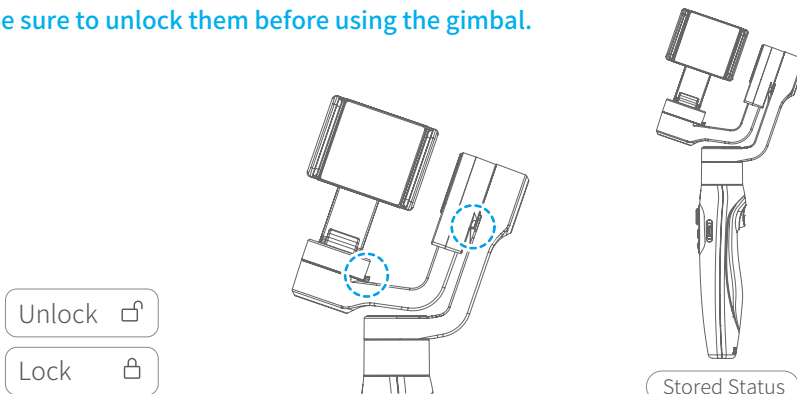

2.3 Smartphone Installation

Place smartphone in holder so that the phone is snug against the back of the holder.

- It's recommended to remove your smartphone protective case.

Smartphone holder width range : 57-84mm.

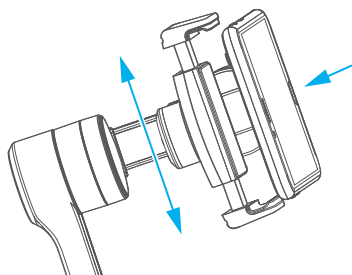

2.4 Balancing (Balancing before power on)

If the smartphone tilts to left or right after installed the smartphone, please slide the cross arm to the opposite direction which the smartphone tilts to to balance.

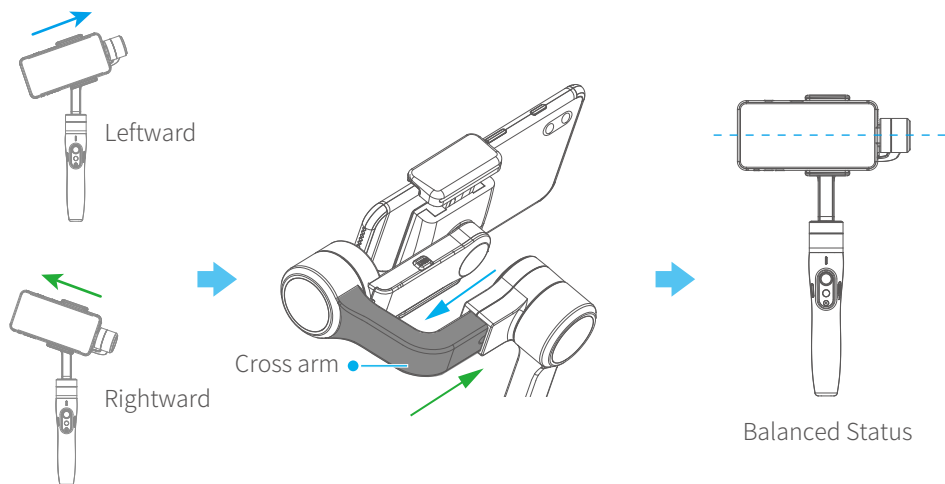

2.5 Power ON / OFF

Make sure unlock the roll and pan lock before powering on the gimbal.

Power ON Long press the function button and release it when you hear the tone.
(Green light will change to blue)

Power OFF Long press the function button and release it when you hear the tone.
(The red light will turn off)

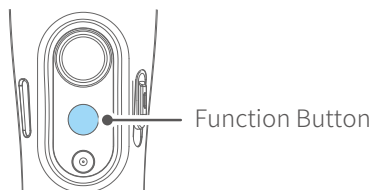

3. Function Operation

3.1 Function / Modes Introduction

Pan Mode (Default mode)

The roll and tilt direction are fixed, and the smartphone moves according to the left-right movements of the user's hand.

Lock Mode

The orientation of the smartphone is fixed.

Follow Mode

The roll direction is fixed, and the smartphone moves according to the left-right movements, up-down movements of the user's hand.

Reset

Return to panning mode, three axes return to default position.

Manual Lock

Slide the tilt axis to one position for shooting.

Landscape and Portrait Shot

Assist landscape or portrait shooting.

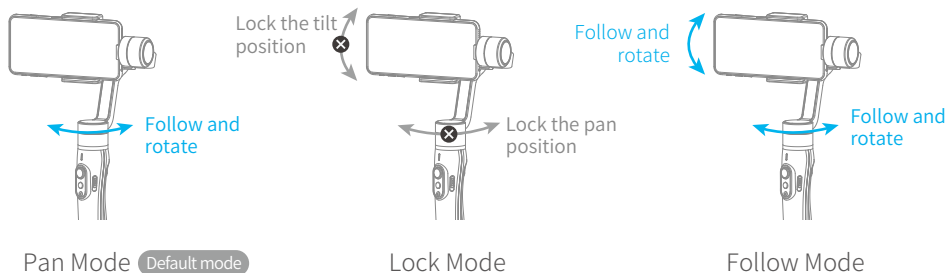

3.2 Joystick

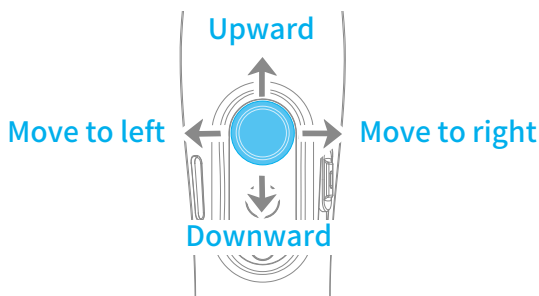

3.3 Function Button Operation

Function button	Function
Single tap	Pan Mode (Click once)
	Lock Mode (Click again)
Double tap	Follow Mode [*]
Triple tap	All Follow Mode [*]
Quintuple tap	Gimbal Initialization (Single click the function button to wake up)
Long press	Power ON / OFF

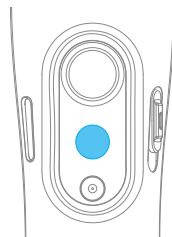

^{*} The button's operation function can be modified on App, after connecting Feiyu ON App succeeded.

3.4 Shutter Button Operation

The gimbal can control the photography after only Bluetooth is connected with smartphone.

Connect Smartphone

Bluetooth connection

- (1) Power on the gimbal, open smartphone bluetooth.
 - (2) Choose below Bluetooth connection way:
 - a. Choose Vimble 2S Bluetooth to connect like FY_Vimble2S_xx.
 - b. Open Feiyu ON app, logon or register via tips to connect.
 - (3) After Bluetooth connecting successful, the shutter button is activated.
- The green light flashes once while other indicator status (About every 5 seconds flashes once)

Shutter Button	Function	Control the App Feiyu ON	Control smartphone camera* via bluetooth
Single click	Photography	✓	✓
	Video (Click again to end the recording the video)	✓	✓
Double click	Switch to photo / video mode	✓	×
Triple click	Switch front and rear camera	✓	×
Long time press	Video recording in shooting mode (Long press the shutter button again to end the recording)	✓	×

* We suggest close Feiyu ON App when you control smartphone camera.

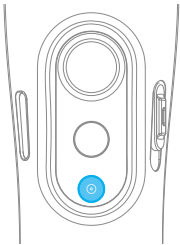

3.5 Focus Button Operation

Focus Button	Function
Sliding up-down	Adjust focus (Adjust field-of-view)

Used with Feiyu ON App

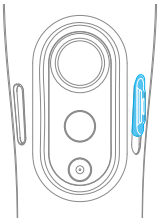

3.6 Trigger Button Operation

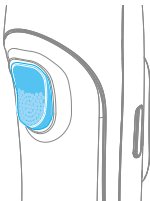

Trigger Button	Function
Long press	Enter follow mode* (Release trigger button enter into previous mode)
Double tap	Reset



* The button's operation function can be modified on App, after connecting Feiyu ON App succeeded.

3.7 Light Indicator Explanation

■ The current mode of the stabilizer can be identified by the indicator status.

Indicator	Indicator status	Mode / Status
 Blue light	Flashes once	Pan Mode
	Flashes twice	Follow Mode
	Constant	Lock Mode / Initialization
	Keeps flashing	Initialization failure / Malfunction
 Green light	Green light change to blue	Power on
	Flashes once	Photo
	Constant	Video
	Green light flashed once in 5 seconds While other indicator status	Bluetooth connected
 Red light	Flashes three times	Power off
	Flashes three times	Low power
	Keeps flashing	Gimbal powering off

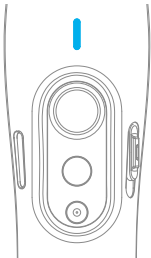

3.8 Trigger Button Operation

Manually move camera to desired position, and hold for half a second, new tilt position is automatically saved.

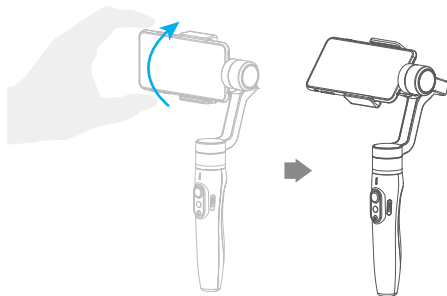

3.9 Landscape and Portrait Shot Switching

Press buttons to switch Effected only when tilt axis on right side.

Hold the gimbal horizontally, press and hold the trigger button, and then single tag function button to switch between landscape and portrait mode.

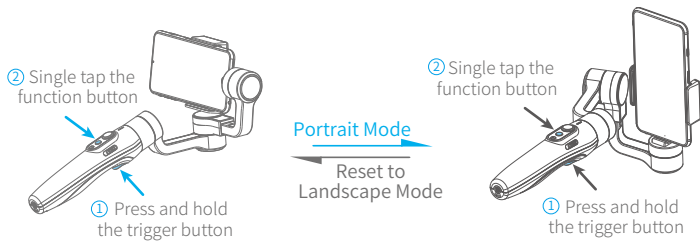

Rotate the Smartphone Holder to switch

Switching portrait /landscape mode by manually rotate the smartphone holder left or right.

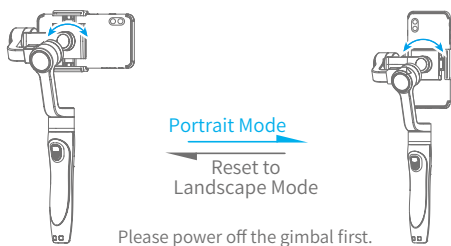

Payload in portrait mode

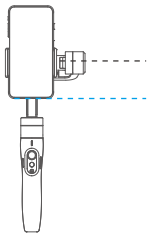

Load weight:
100~200g

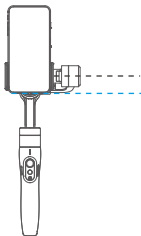

Load weight:
≤130g

3.10 Gimbal Initialization

Initialize gimbal when:

- Smartphone fails to remain level.
- Gimbal has not been used for a long period of time.
- Gimbal is used in extreme temperature variations.

STEP

- (1) Click the function button five times. The motors will stop working. Status indicator turns solid blue.

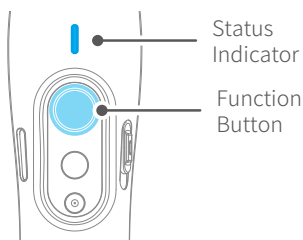

- (2) Place the gimbal on a flat, horizontal surface. The gimbal will automatically initialize after a few seconds detecting no movement. The blue light will flash three times to indicate end of initialization.

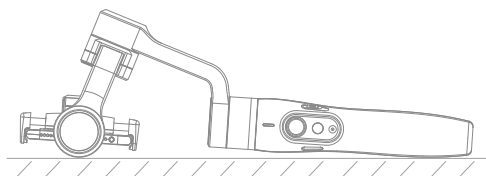

- (3) After the initialization is successful, click the function button to wake up.

Note: if the initialization is not successful, click the function button to wake up. restart initialization process.

3.11 Smartphone Charging

Charge the smartphone via cable and choose the corresponding cable according to charging port.

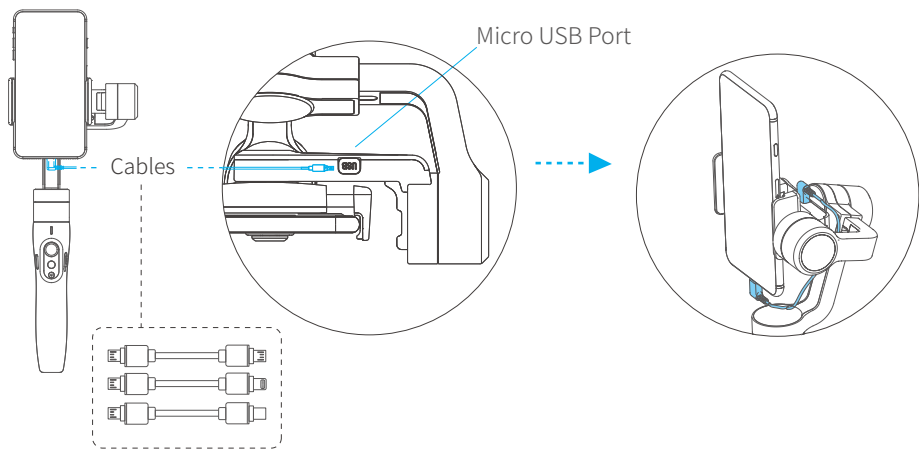

4. Connect and Use Feiyu ON App

4.1 Download the App



Feiyu ON



Scan the QR code to download the app, or search for "Feiyu ON" in the App Store or Google Play.

* Requires iOS 9.0 or above, Android 6.0 or above.



iOS Version



Android Version



App Store



Google play

4.2 Connect the App

Open Feiyu ON app and connect the gimbal via tips.

Format Bluetooth of gimbal: FY_Vimble2S_XX

4.3 Shooting / control interface

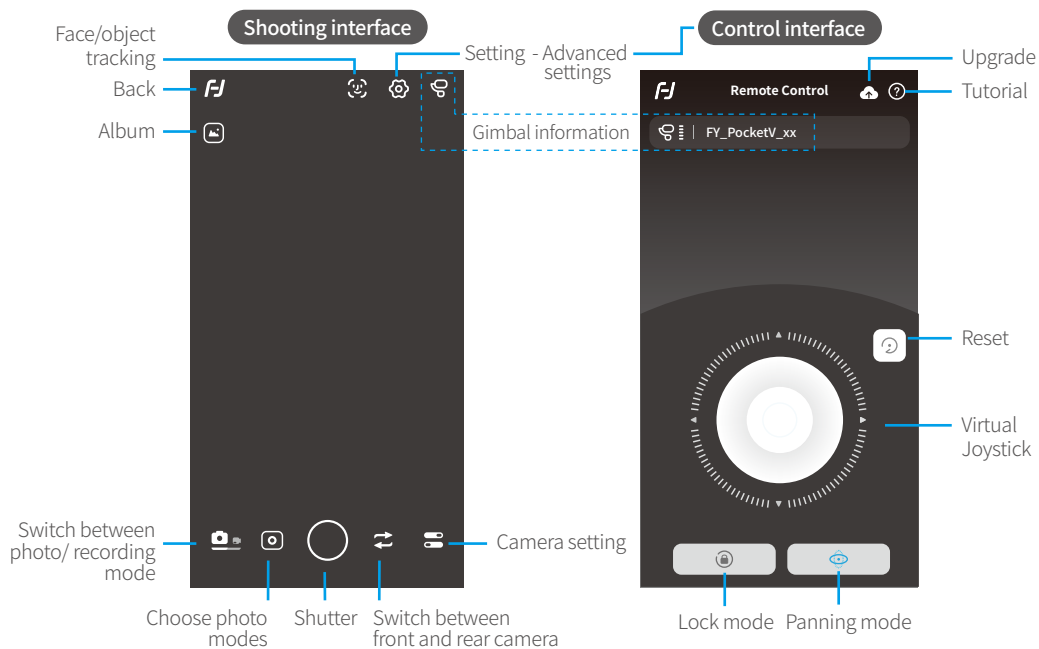

4.4 Firmware Upgrade

Upgrade the firmware through the App.

- (1) Click the icon 
- (2) Select upgrade type.
- (3) Follow the prompts to upgrade the firmware.

Upgrade type introductions:

Keyboard firmware update: Repair / update or newly add button/touch screen/interaction functions, update more compatibility cameras which can be controlled through WIFI, repair few bugs about camera control through WIFI, and etc.

Bluetooth firmware update: Repair / update or newly add Bluetooth functions, update more compatibility cameras, and etc.

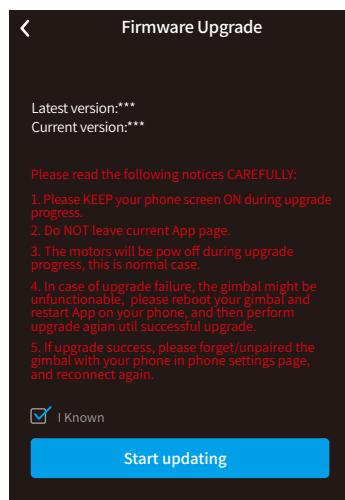

5. Specifications

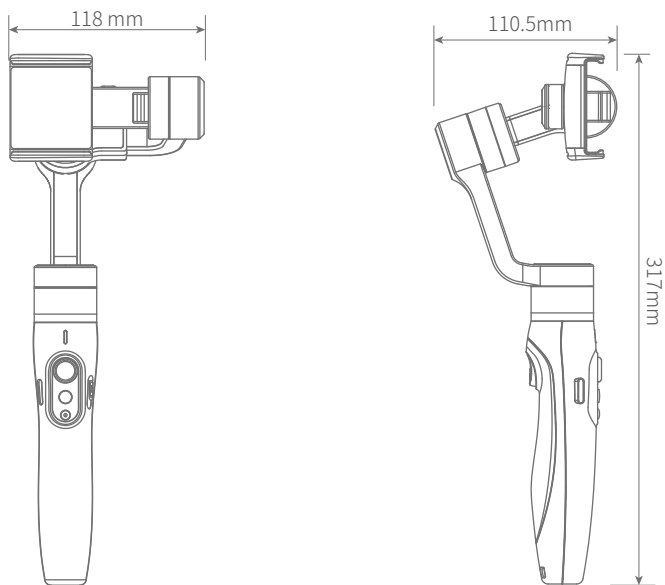

Max. Tilting Range	320°
Max. Tilting Range	320°
Max. Panning Range	320°
Operation Time	12 Hours
Weight	272g (Not including the smartphone)
Payload	210g (After balanced)
Adapter smartphones	iPhone and Android phones (Width range 57-84mm)

Disclaimer

Thanks for using Feiyu Gimbal. The information in this document affects your safety and your legal rights and responsibilities. Read the entire document carefully to ensure proper configuration before use. Failure to read and follow instructions and warnings in this document may result in serious injury to yourself or others, or damage to your products or damage to other objects in the vicinity.

By using this product, you hereby signify that you have read this disclaimer and warning carefully and that you understand and agree to abide by the terms and conditions herein. You agree that you are solely responsible for your own conduct while using this product, and for any consequences thereof. You agree to use this product only for purposes that are proper and in accordance with all applicable laws, rules, and regulations, and all terms, precautions, practices, policies and guideline FeiyuTech has made and may make available. FeiyuTech accepts no liability for damage, injury or any legal responsibility incurred directly or indirectly from the use of product.

FeiyuTech will not provide any service for any product obtained from abnormal channels.

Notice

1. Make sure motor spinning is not blocked by external force when gimbal is power on.
2. Gimbal DO NOT contact water or other liquid if the gimbal is not mark waterproof or splash-proof. Waterproof and splash-proof product DO NOT contact sea water or other corrosive liquid.
3. DO NOT disassembly the gimbal except marked detachable. It need send to FeiyuTech after-sales or authorized service center to fix it if you accidently disassembly and cause abnormal work. The relevant costs are borne by user.
4. Prolonged continuous operation may cause the motor surface temperature to rise, please operate carefully.
5. DO NOT drop or strike batteries. If the battery is abnormal, contact Feiyu After-sales support.

Storage and Maintenance

1. Keep the gimbal and battery out of the reach of children and pets.
2. DO NOT leave the gimbal and battery near heat sources such as a furnace or heater. DO NOT leave the gimbal and battery inside of a vehicle on hot days.
3. Please storage the battery in dry environment.
4. DO NOT overcharge or overuse the battery, otherwise it will cause damage to the battery core
5. Never use the gimbal and battery when the temperature is too high or too low.

Official Social Media



Website



Facebook



Youtube



Twitter



Instagram

Facebook: www.facebook.com/feiyutech

YouTube Channel: www.youtube.com/c/Feiyu-tech

Twitter: www.twitter.com/feiyutech

Instagram: www.instagram.com/FeiyuTech

YouTube Channel: www.youtube.com/c/Feiyu-tech

Online Store: store.feiyu-tech.com



Guilin Feiyu Technology Incorporated Company

For more information, please visit our official website www.feiyu-tech.com

E-mail: service@feiyu-tech.com Tel: +86 773 2320865

Due to software and hardware improvements, your actual product might differ from the descriptions and pictures in this user manual. You can get the latest user manual from the official website.